

Roger Sillolard

Temple de la Liberté
(1939) 36/40

Vieillard Roger Roger, graveur (1907-1989), *Temple de la liberté*, 1938, gravure au burin, 23.3x17.5cm, coll. de la famille de l'artiste.

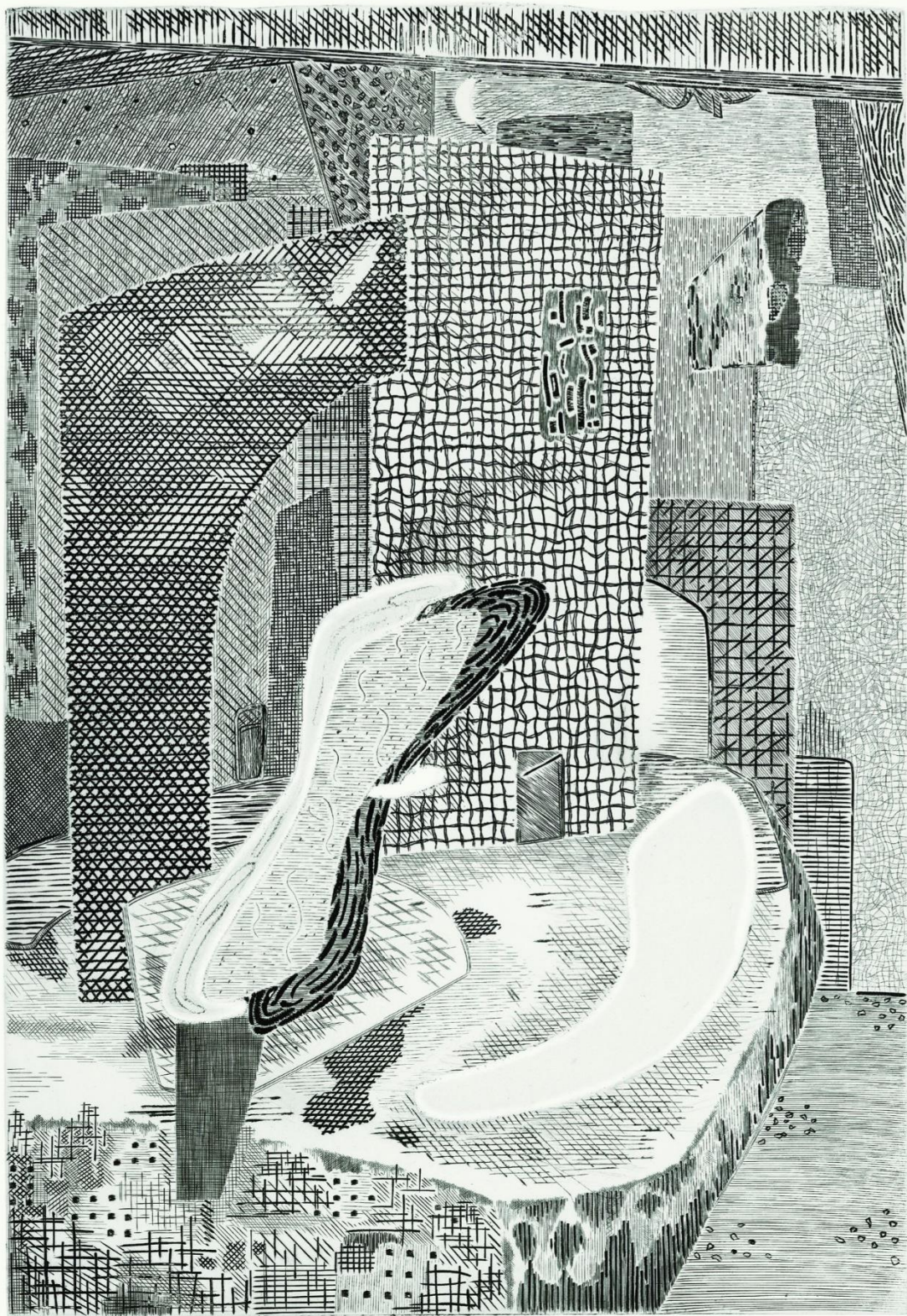

Vieillard Roger, graveur (1907-1989), *L'aventure nocturne*, 1966, gravure au burin, (23,8 x 34,7cm), coll. part.

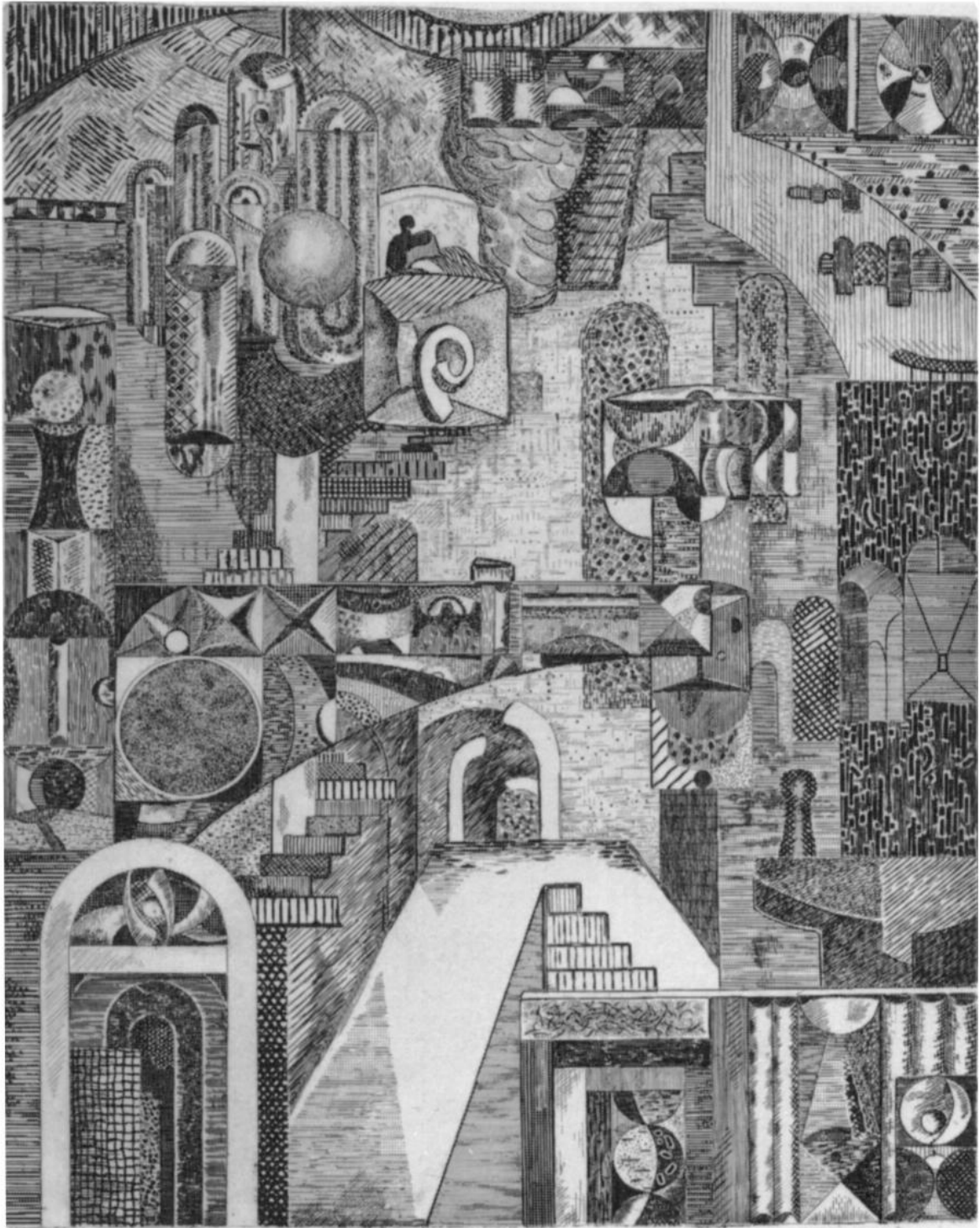

Roger Wastland 1975

A L'Atelier

Vieillard Roger, graveur (1907-1989), *Atelier*, 1972, gravure au burin, 43.4 x 34.1 cm, coll. de la famille de l'artiste.

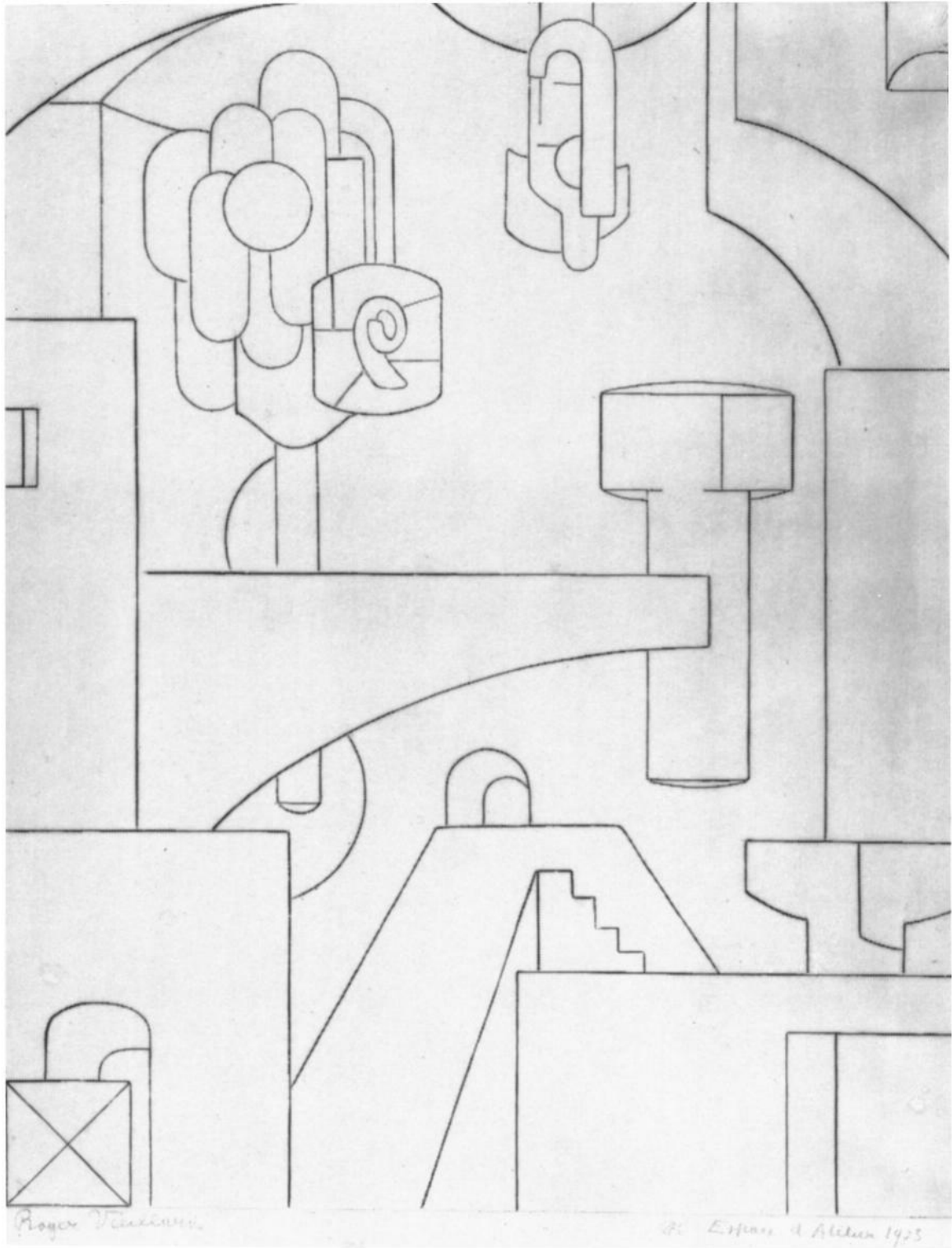

Vieillard Roger, graveur (1907-1989), *Atelier II*, 1973, gravure au burin, 43.4 x 34.1 cm, coll. de la famille de l'artiste.

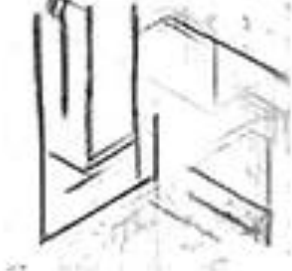
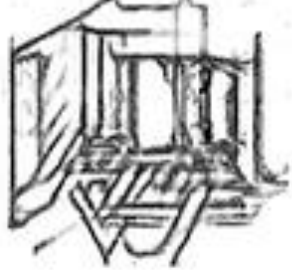
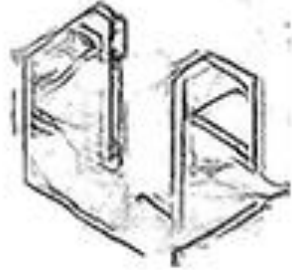
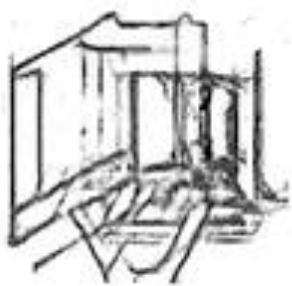
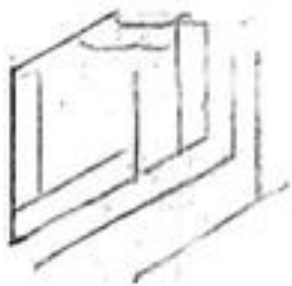
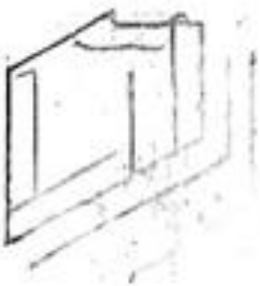
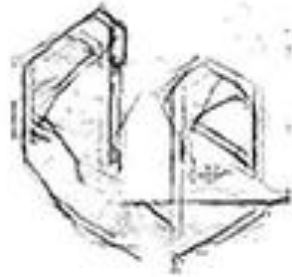

GENERATION 15

Dunne & Raby, (studio de design créé en 1994) *In Search of an Impossible Object*, 2018.

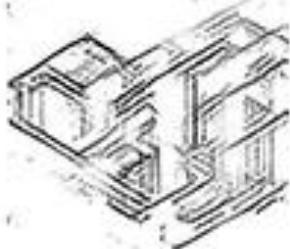
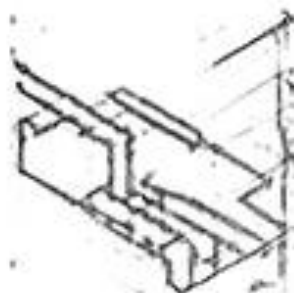
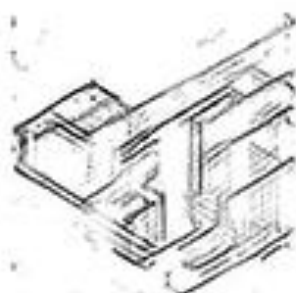
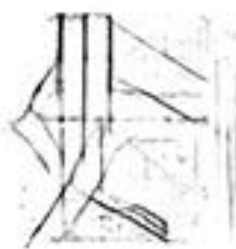
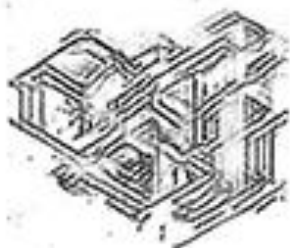

GENERATION 7

Dunne & Raby, (studio de design créé en 1994) *In Search of an Impossible Object*, 2018.

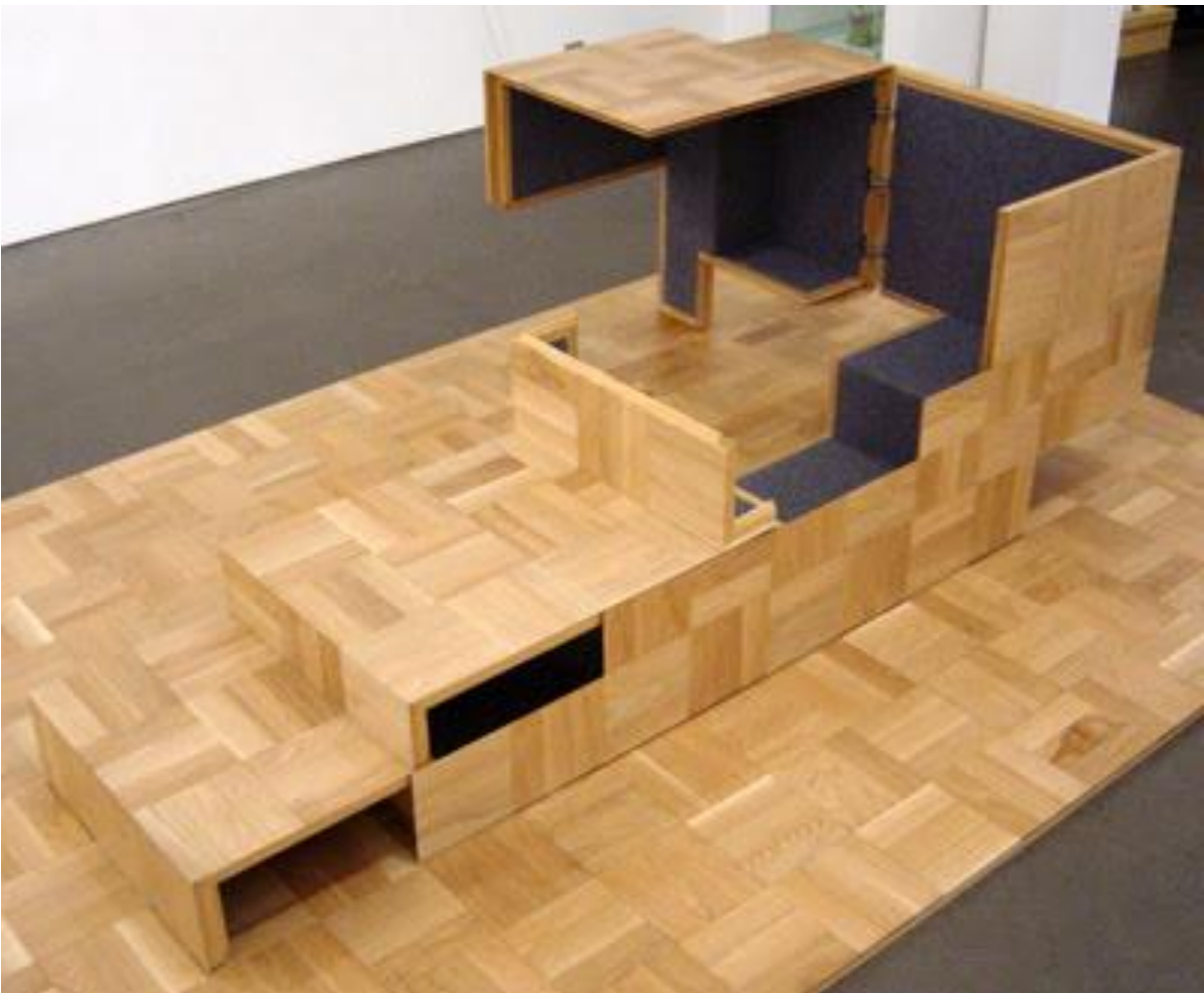

Dunne & Raby, (studio de design créé en 1994), *Furniture Type 2 is part of the Designs for Fragile Personalities in Anxious Times series, 2004-2005.*

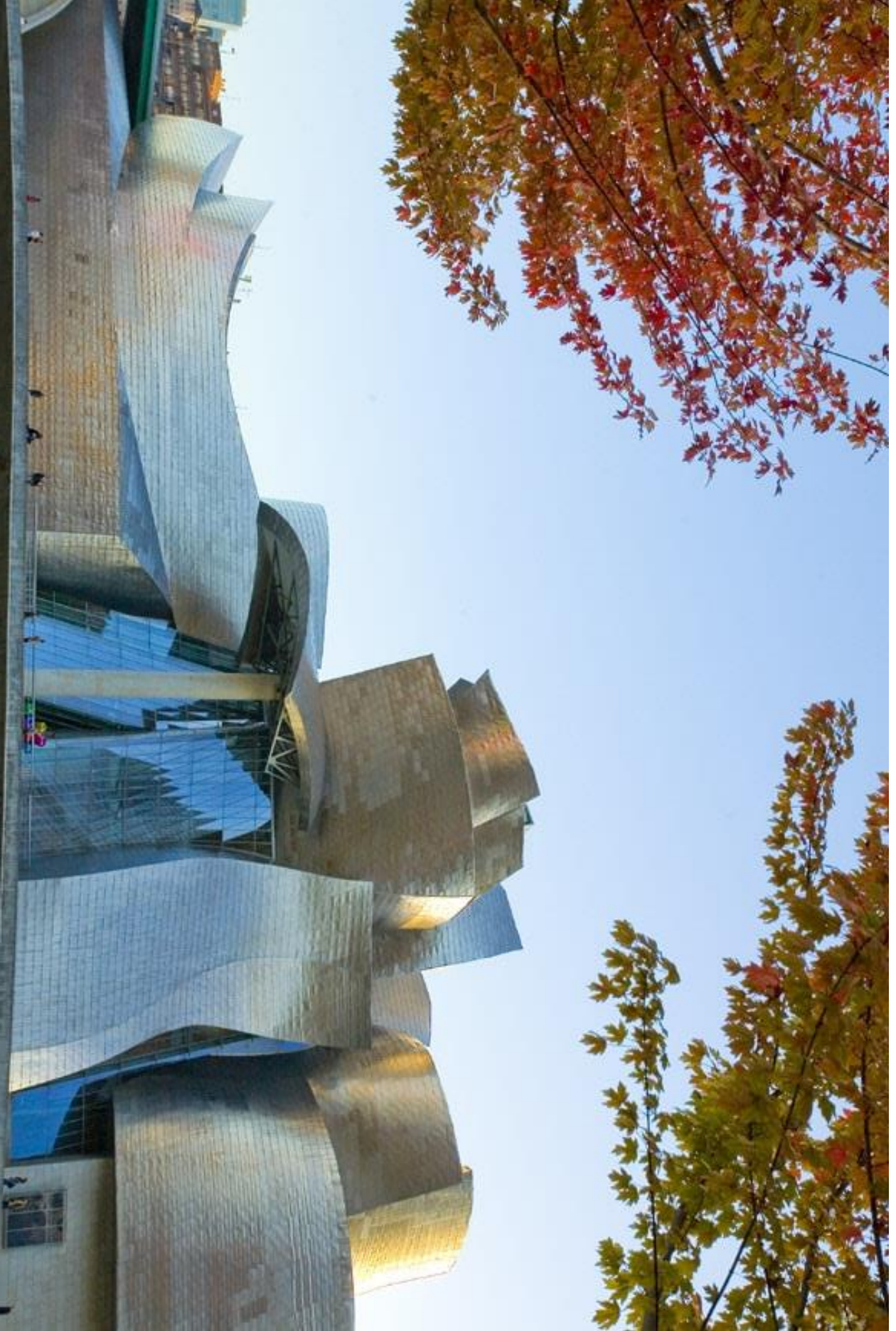

Gehry Frank, architecte, (1929 -), *Guggenheim Bilbao, Façade Nord*, 1997.
Photo : Erika Ede



Gehry Frank, architecte, (1929 -), *Guggenheim Bilbao*, 1997. Photo : Olivier Dubois

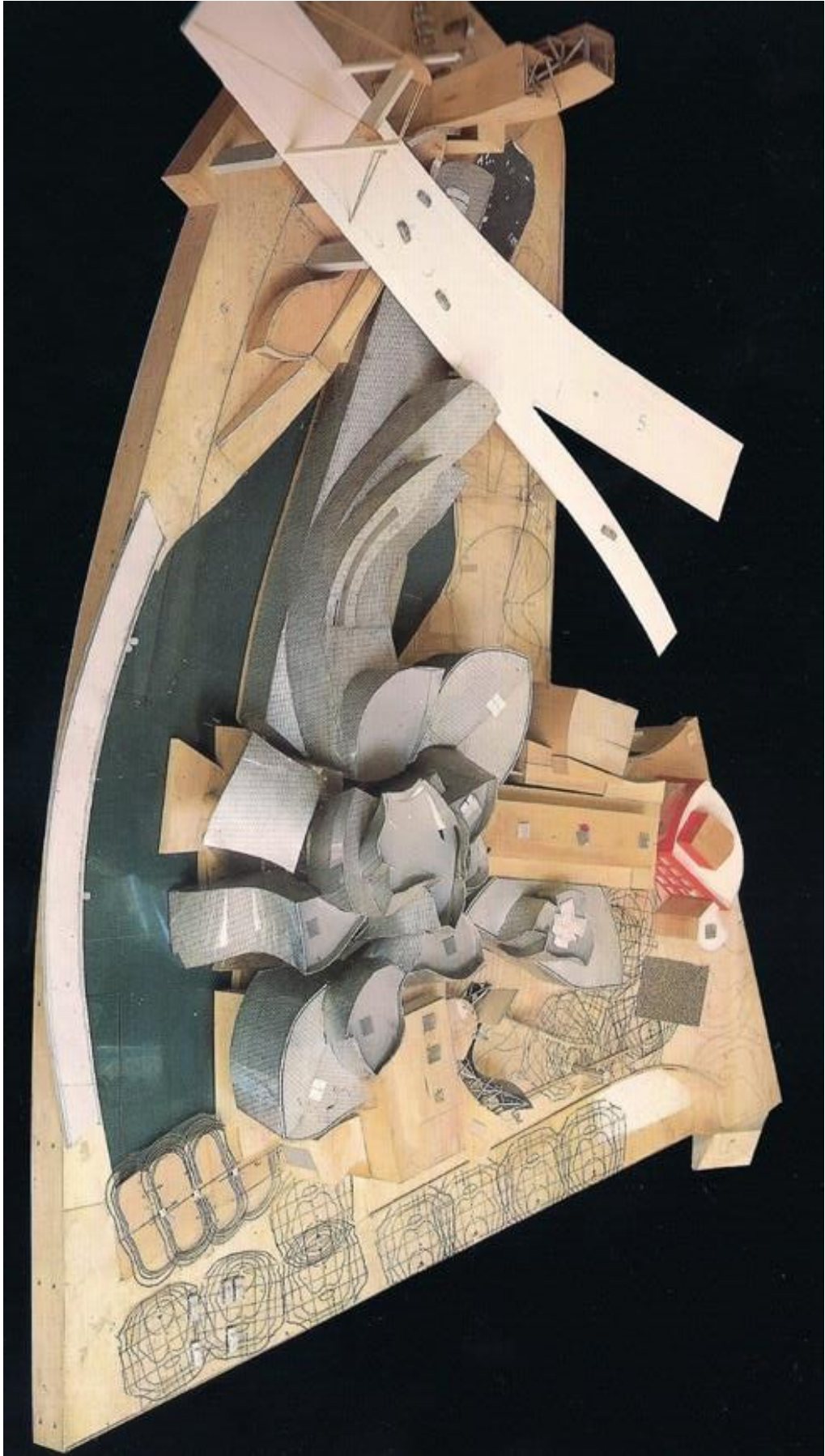

Gehry Frank, architecte, (1929 -), *Guggenheim Bilbao*, 1997, Maquette par
Gehry Partners LLP.

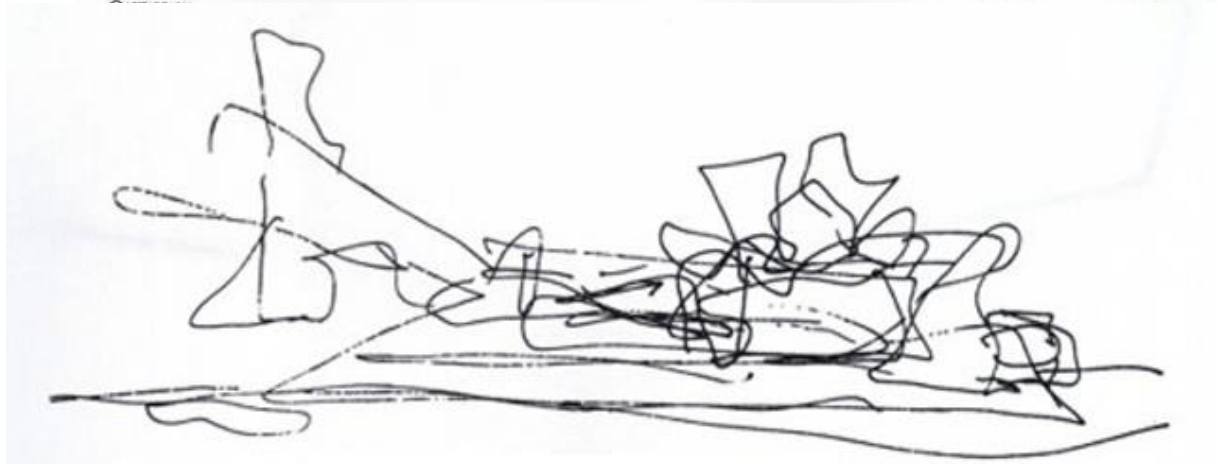
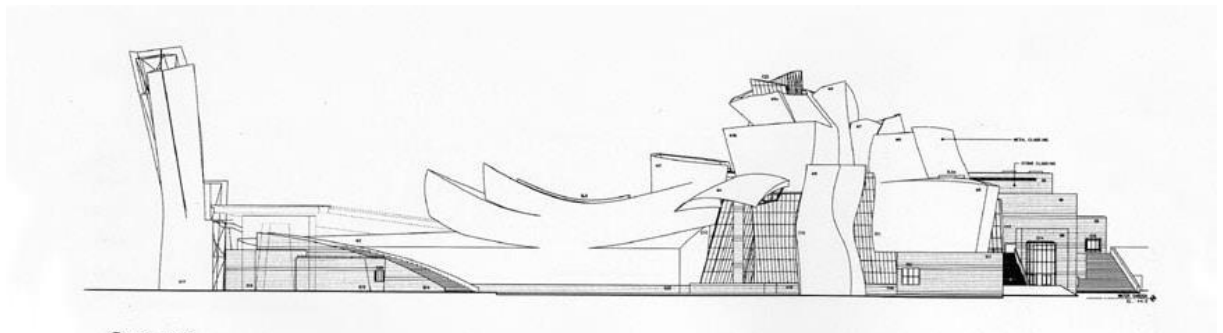
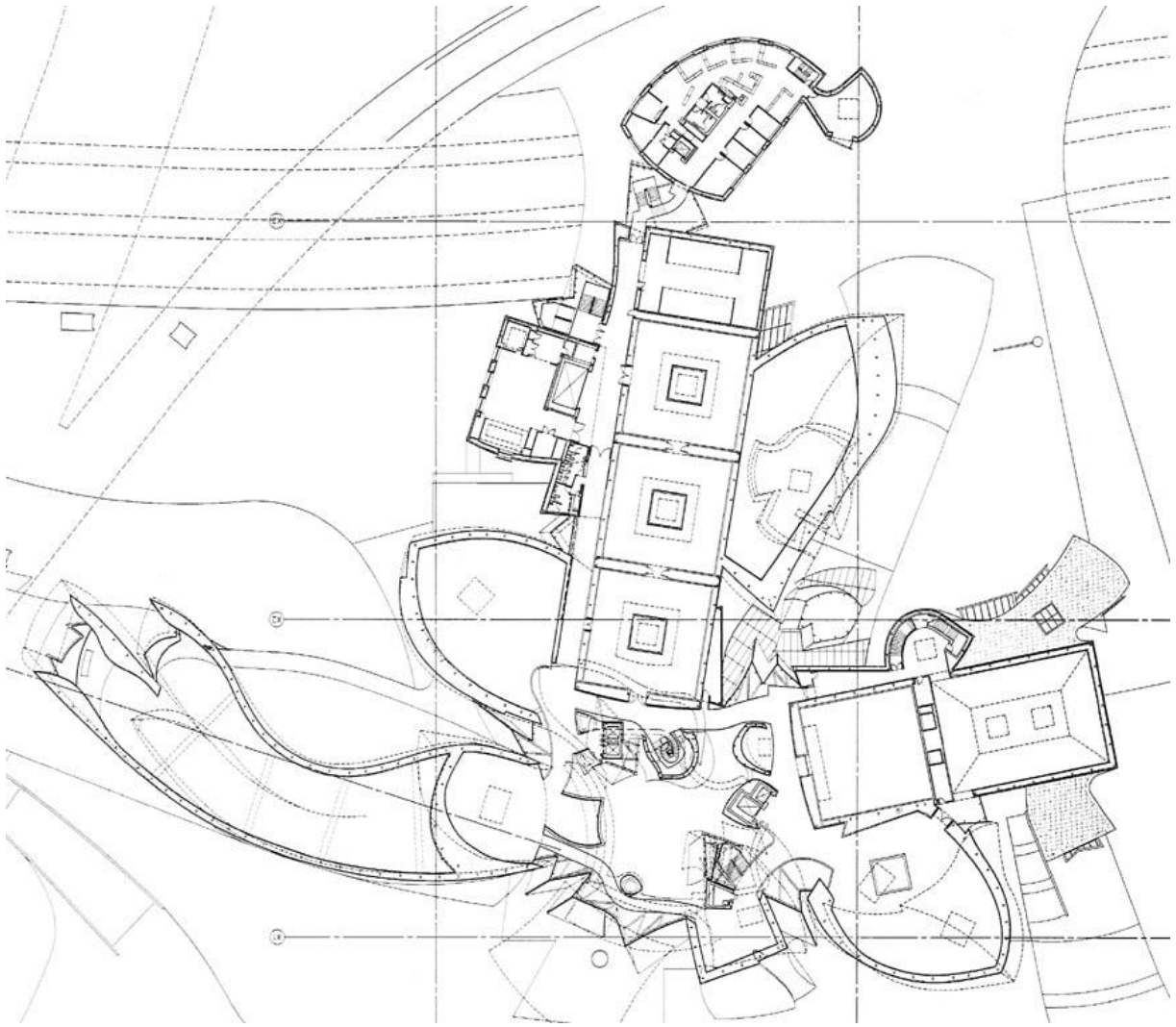

Gehry Frank, architecte, (1929 -), *Guggenheim Bilbao*, 1997, plan du 1er étage
et élévation nord, par Gehry Partners LLP.

Gehry Frank, architecte, (1929 -), *Guggenheim Bilbao*, 1997, croquis
préparatoire de l'artiste.



Absalon, artiste, (1964-1993), *Propositions d'habitations*, 1990, bois, plâtre, carton, néon, Paris, Fondation Cartier.



Absalon, artiste, (1964-1993), *Cellules*, 1991, Carton ondulé, carton plume, peinture, agrafes, clous, Ensemble de 6 maquettes, Paris, CNAP.



Absalon, artiste, (1964-1993), *Cellules d'Habitation*, 1990-1993, Paris Galerie
Chantal Croussel.

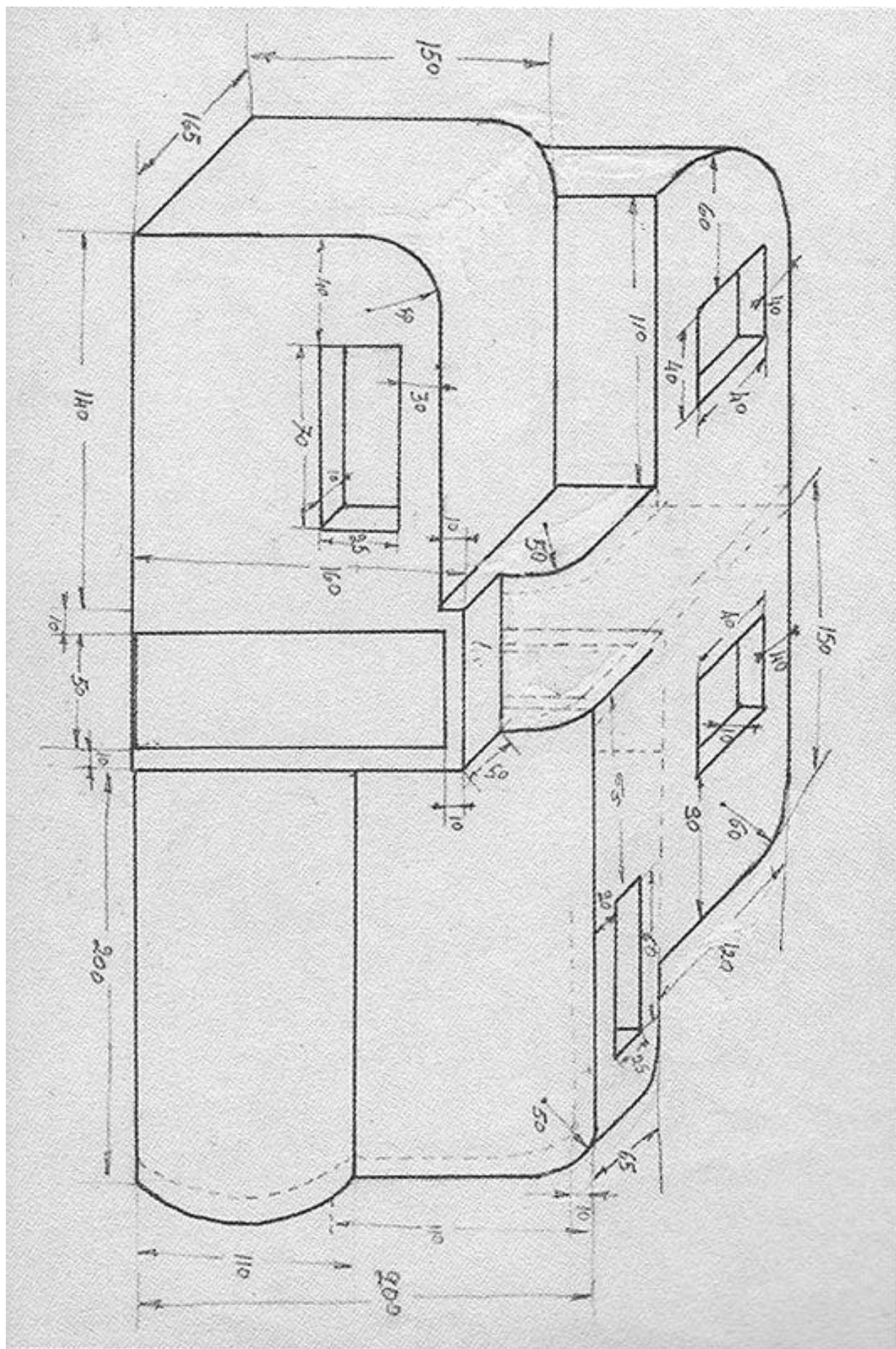

Absalon, artiste, (1964-1993), *Cellules d'Habitation*, 1990-1993, plan, Paris
Galerie Chantal Croussel.



Superstudio, (collectif d'architectes fondé en 1966), Vue de l'exposition
Superstudio, la vie après l'architecture, Frac Centre-Val de Loire, 2019.

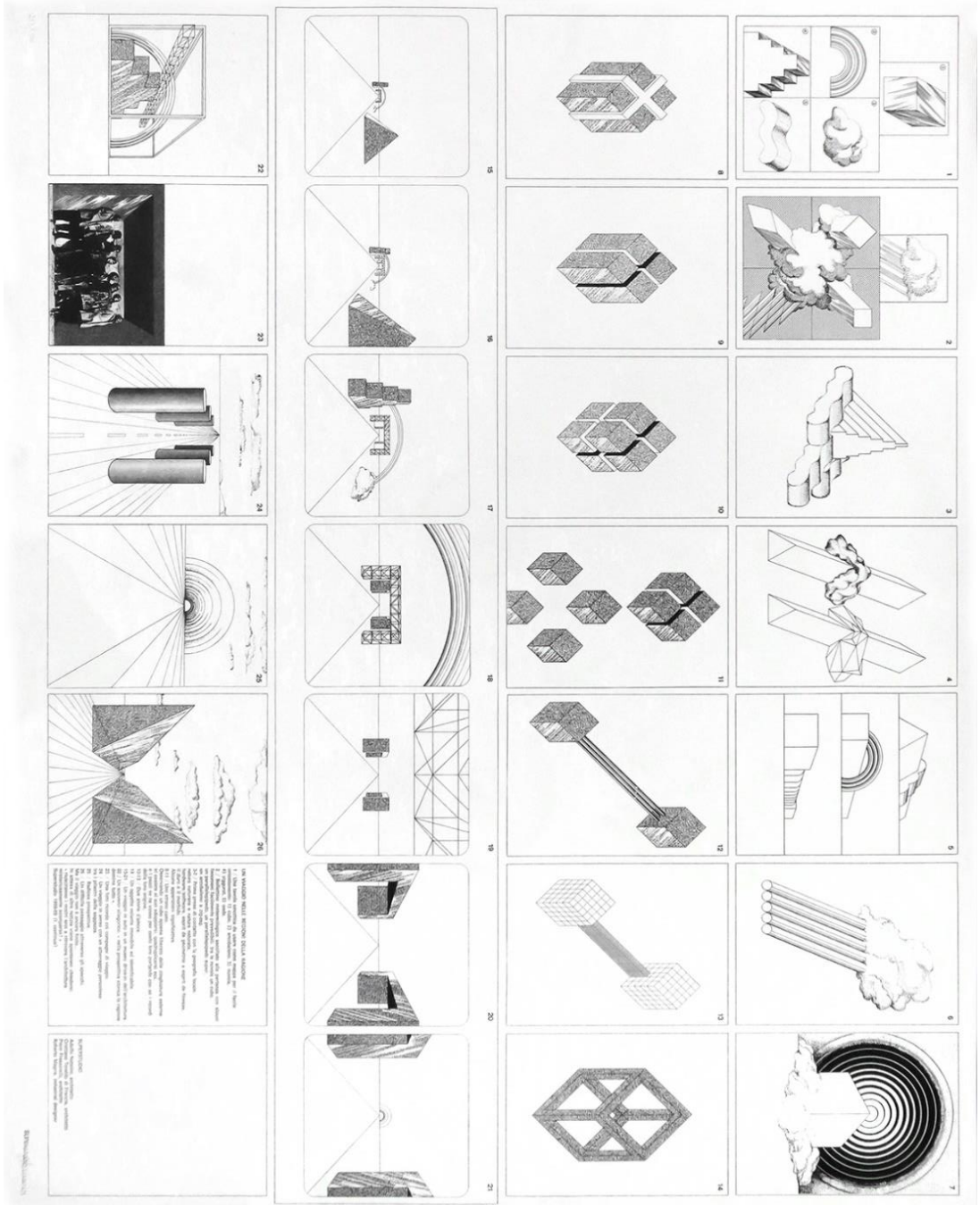

1. 3D model of a cube with a diagonal cut. 2. 3D model of a complex structure with a central mass and radiating elements. 3. 3D model of a series of parallel, slightly offset rectangular blocks. 4. 3D model of a structure with a central mass and radiating elements, similar to panel 2. 5. 3D model of a cube with a diagonal cut, similar to panel 1. 6. 3D model of a cube with a diagonal cut, similar to panel 1. 7. 3D model of a structure with a central mass and radiating elements, similar to panel 2. 8. 3D model of a cube with a diagonal cut, similar to panel 1. 9. 3D model of a cube with a diagonal cut, similar to panel 1. 10. 3D model of a cube with a diagonal cut, similar to panel 1. 11. 3D model of a cube with a diagonal cut, similar to panel 1. 12. 3D model of a cube with a diagonal cut, similar to panel 1. 13. 3D model of a cube with a diagonal cut, similar to panel 1. 14. 3D model of a cube with a diagonal cut, similar to panel 1. 15. 3D model of a cube with a diagonal cut, similar to panel 1. 16. 3D model of a cube with a diagonal cut, similar to panel 1. 17. 3D model of a cube with a diagonal cut, similar to panel 1. 18. 3D model of a cube with a diagonal cut, similar to panel 1. 19. 3D model of a cube with a diagonal cut, similar to panel 1. 20. 3D model of a cube with a diagonal cut, similar to panel 1. 21. 3D model of a cube with a diagonal cut, similar to panel 1. 22. 3D model of a cube with a diagonal cut, similar to panel 1. 23. 3D model of a cube with a diagonal cut, similar to panel 1. 24. 3D model of a cube with a diagonal cut, similar to panel 1. 25. 3D model of a cube with a diagonal cut, similar to panel 1. 26. 3D model of a cube with a diagonal cut, similar to panel 1. 27. 3D model of a cube with a diagonal cut, similar to panel 1. 28. 3D model of a cube with a diagonal cut, similar to panel 1. 29. 3D model of a cube with a diagonal cut, similar to panel 1. 30. 3D model of a cube with a diagonal cut, similar to panel 1.

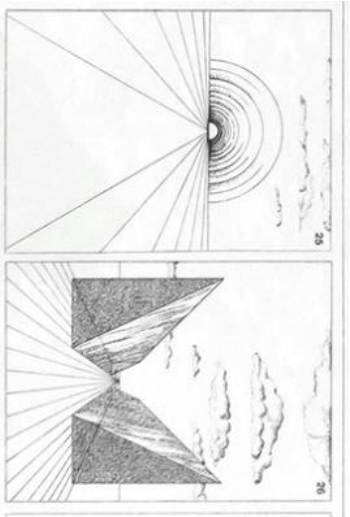
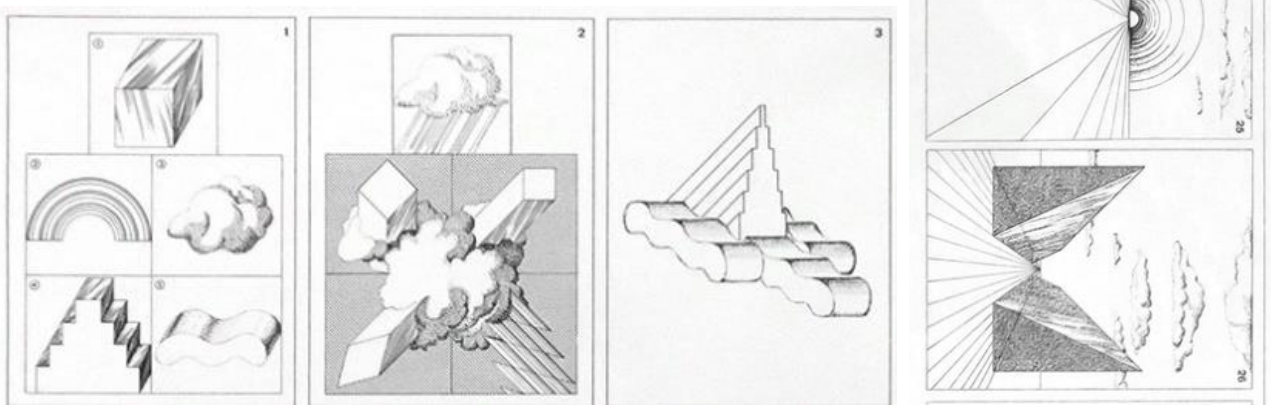

Superstudio, (collectif d'architectes fondé en 1966), *Un viaggio nelle regioni della ragione III*, 1968-1969, sérigraphie, 86,5 x 68,5 cm, coll. part.

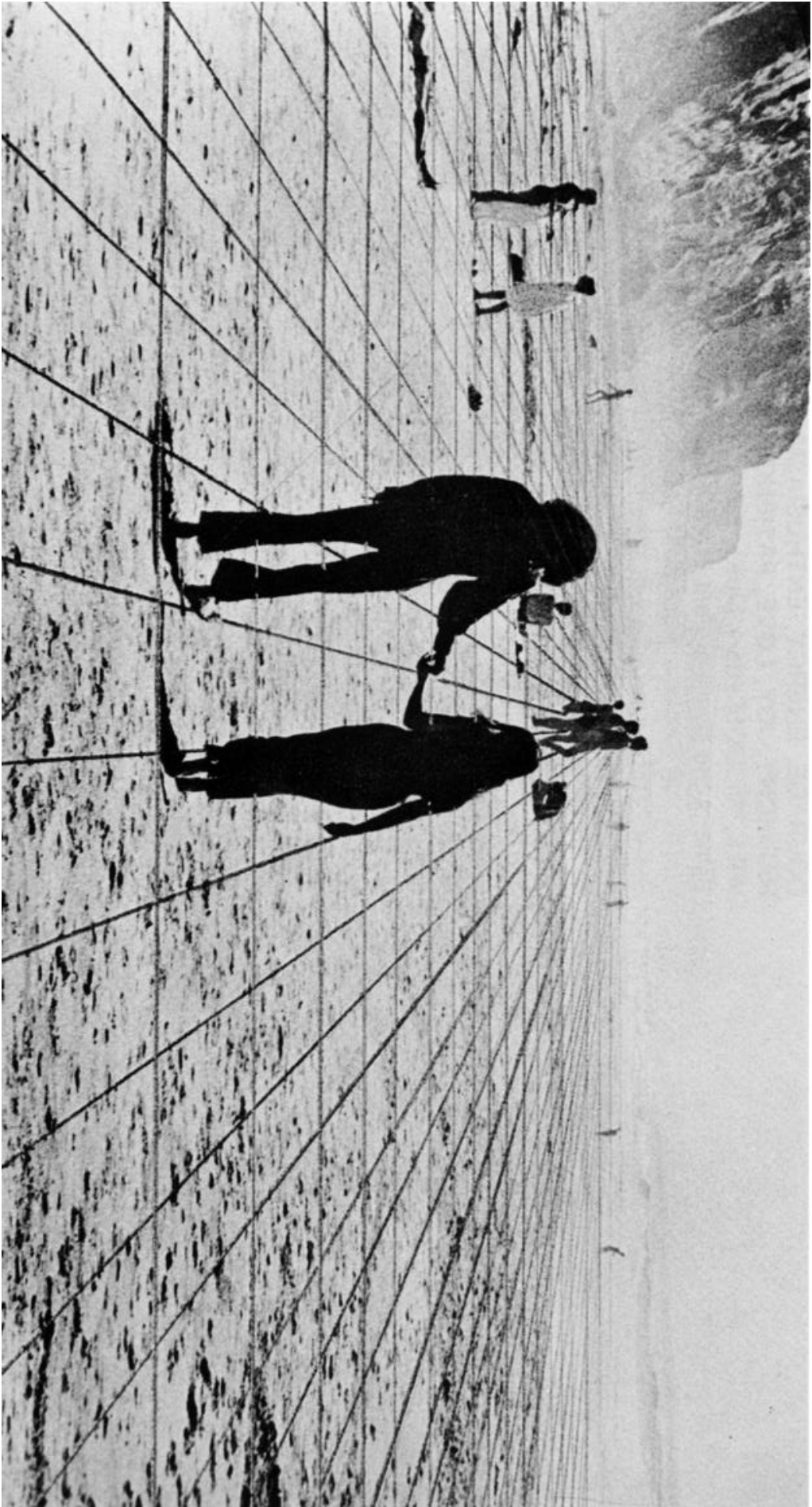

Superstudio, (collectif d'architectes fondé en 1966), Superstudio, Gli Atti
Fondamentali, Vita (Supersuperficie), Viaggio da A a B, 1971.